

10.4" LCD Open frame SAW/RESISTIVE Touch Monitor

(Dust-proof Type)

KOT-0104U-SA4BP



Shenzhen K&JAD Technology Co., Ltd

Nov.2013

Keetouch's 10.4" Dust-proof open frame LCD touchmonitors have a long-lasting product cycle because the enclosure is controlled by Keetouch's specifications. Future panel improvements are therefore possible without external changes. The KOT-0104U-SA4BP integrate with the Keetouch's SAW/RESISTIVE technology touchscreen.

Features

- Long lasting product cycle-enclosure controlled by Keetouch specifications
- Future generation panels phased-in without external changes
- High quality panel with high brightness,high contrast ratio and broad viewing angle
- Multiple mounting options including horizontal bracket-mount,vertical bracket mount and VESA mount
- Keetouch's SAW/RESISTIVE technology on pure glass for the ultimate in image quality
- Easy integration from side
- Finger operation
- USB touch interface port
- VGA input video format
- Worldwide agency approvals

Specification

Model No.	KOT-0104U-SA4BP	
Series	OT, Dust-proof	
Display Type	4:3Ratio 10.4 " Active matrix TFT-LCD	
Active Area	211.2×158.4(mm)	
Monitor Dimensions	Width: 257mm Height: 199mm Depth: 45.5mm	
Suggested Resolution	800×600 (SVGA)	
Support Colors	16.2M	
Brightness(Typ.)	Pure LCD Panel	300cd/m ²
	With SAW/RESISTIVE Glass sensor	270cd/m ²
Response Time(Typ.)	30ms	
Viewing Angle (Typ.at CR>10)	Horizontal(left/right)	75°/75°
	Vertical(up/down)	50°/60°
Contrast Ratio(Typ.)	500:1	
Video Input	VGA	
Frequency (H/V)	30~80KHz / 60~75Hz	
Power Supply	Type: External brick Input (line) voltage: 100-240 VAC, 50-60 Hz	
Environment	Operating Temp.	0~50°C
	Storage Temp.	-20~60°C
	Operating RH:	20%~80%
	Storage RH:	10%~90%
MTBF	50,000 Hours	
LED Back light Life(Typ.)	50,000 Hours	
Weight (N.W/G.W)	2.25Kg (1pcs) / 6.55Kg (2pcs in one package) (Approx.)	
Out package dimensions	330×220×280 (mm)	
Power Consumption	15W Max.	
Standby power consumption		
Mount Interface	Mount bracket, horizontal or vertical and VESA mount (Standard mount brackets are supplied)	
OSD Control	Buttons	AUTO,+,POWER,-,MENU
	Function	Brightness, Contrast Ratio, Auto-adjust, Phase, Clock, H/V Location, Languages, Function, Reset
Touch screen Type	10.4" SAW/RESISTIVE touch screen sensor	
Touch System Interface	Having USB interface	

Touch Response time	USB: 8.4ms
Agency Approval	CCC,ETL,FCC,CE,RoHS
Regular Warranty	1 year

NOTE:The display SPEC. will change follow the relevant LCD panel brand and model

Mechanical Dimensions

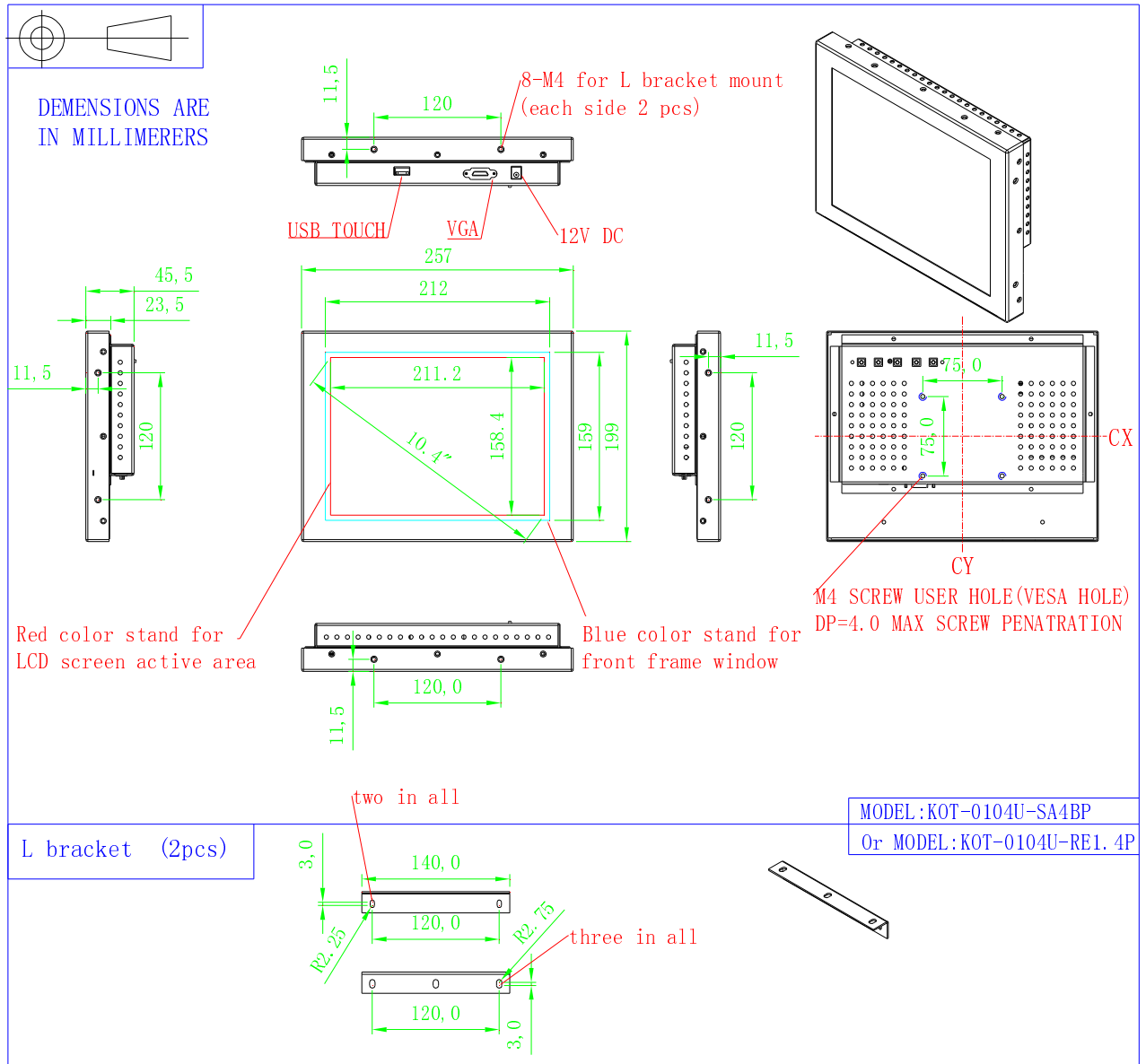

Accessories

Power Cable: A North American power cable or an European power cable or a Chinese Standard power cable is included according to the end user's area.

Power Supply Brick: A power supply brick is included.

Touch/Video Cables: USB touch cable, video cable are included.

Mount bracket:A pair of standard mount bracket for horizontal or vertical mounting

Typical Application

Gaming/Casino Systems
Outdoor and indoor Kiosks
Entertainment
Transport and Ticketing
Hospitality
Banking
Customized Solutions